

Announcement from the organizers

31st ICEPP symposium

Taikan Suehara, Atsushi Oya

Oral presentations

- At room 217 (this room)
- Please use the shared PC in front of the projector's screen
- Please upload your slide **by the break before your session**
 - If your account is linked to indico, you can upload it yourself
 - If not, please upload it from <https://forms.gle/46aqz3AGznUhSakh6>
(Maybe you need a google account to access)

Poster presentations

- At room 212+214
- From 8:00 pm, Tuesday 18th
- Please upload your slide **by morning 18th**
 - Upload either from indico or [google form](#)
- Put your poster on whiteboard before the session
- Also enjoy pizza and drink

Meals

- Breakfast @dining room on the first floor
 - 7:30 – 8:30 am
 - On 19th after breakfast, collect your luggage and place it in room 212 (poster venue)
- Dinner @dining room on the first floor
 - Today: 19:00 – 20:00
 - 17th and 18th: 18:00 – 19:00
- Lunch: **Not included in this symposium**
 - Restaurant in the ski area or near the hotel

Night session

- At room 211+213
- Every night after the end of all sessions
- We provide drinks and snacks
- **Please keep in mind that other guests are in this hotel**

Coffee

- Coffee machine is available at any time on 1st floor
- Coffee will be delivered to this room for each coffee break

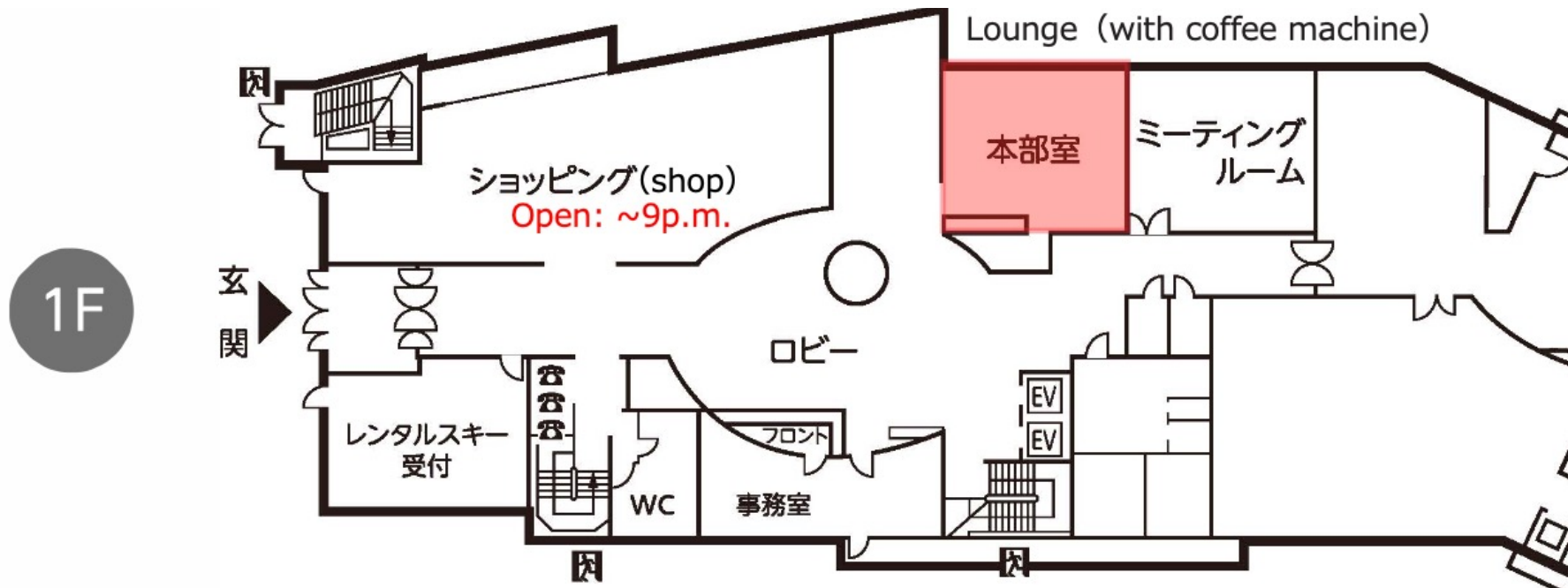

Hot spa (onsen)

- Basement level
- 16:00 – 23:00
- Ski locker is located on the same floor

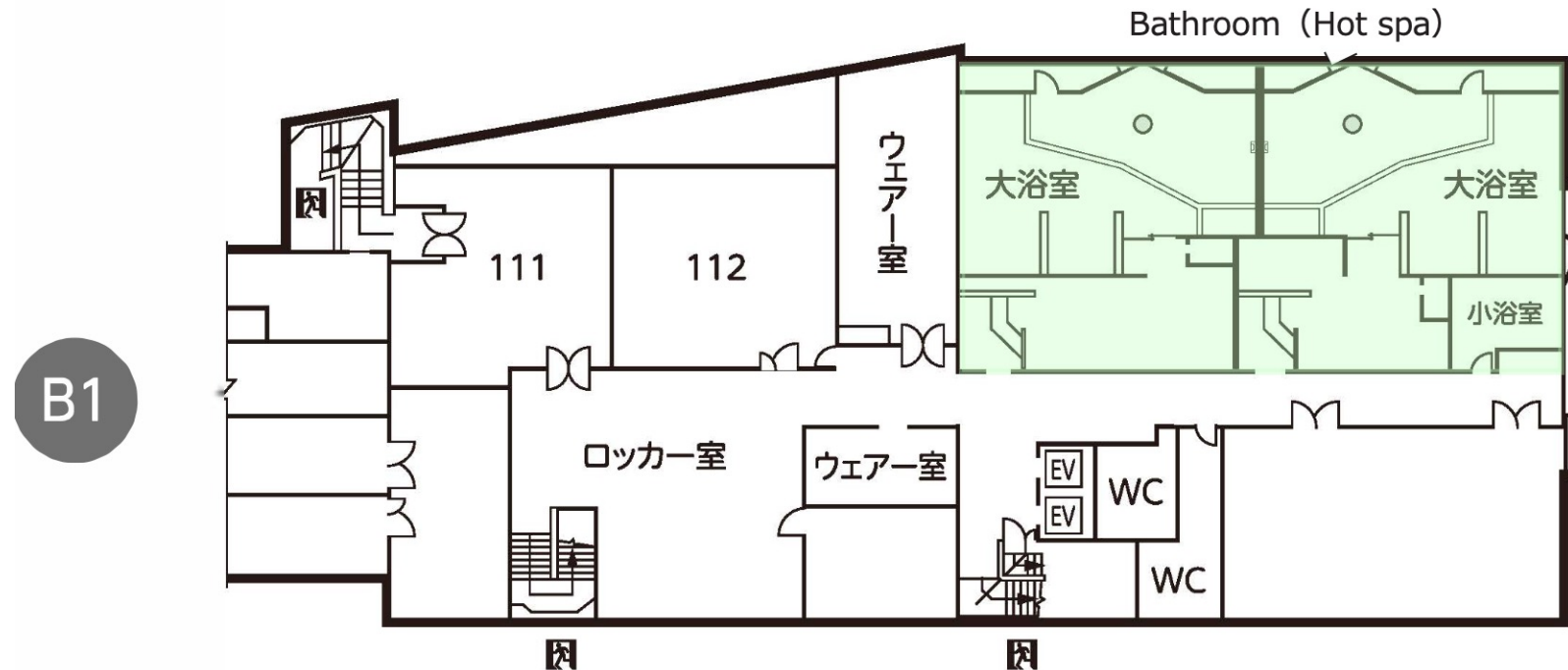

Free time

- Enjoy your activities (skiing, snow hiking, etc)
- Please come back on time
 - 18:00 on 17th
 - 15:00 on 18th
- Please be safe
 - Insurance provided by ICEPP only covers usual activities (skiing inside the boundary)
 - Be careful about the weather

Ski area access

- Hasuike (蓮池) and “Giant” are the closest ski area
- You can download [map around this hotel](#)

Coming back from “Giant”



Enjoy the symposium

- Contact
 - sympo31@icepp.s.u-tokyo.ac.jp
 - 090-7849-0878
- Wifi
 - SSID: shigalake-XXX
 - Password: shigalake